

SMART Heavy Duty Mobile Stand for interactive displays

FS-SBID-200



Hardware

Supported SMART Board displays	SMART Board 6000S and 6000S Pro series SMART Board MX and MX Pro series SMART Board GX series SMART Board 7000R and 7000R Pro series SMART Board 7000 and 7000 Pro series SMART Board 6000 and 6000 Pro series
---------------------------------------	---

Color	Black
--------------	-------

VESA pattern (mm)	Minimum VESA: 200 × 200 mm Maximum VESA: 900 × 600 mm
--------------------------	--

Vertical height settings	58 7/8" (149.4 cm) 55 1/4" (140.4 cm) 51 3/4" (131.4 cm)
---------------------------------	--

Minimum screen size	55" (140 cm) diagonal
----------------------------	-----------------------

Maximum screen size	86" (218 cm) diagonal
----------------------------	-----------------------

Maximum display weight capacity	265 lb. (120 kg)
--	------------------

Maximum stand weight capacity	297 lb. (135 kg)
--------------------------------------	------------------

Wheels	4" industrial-grade locking casters
---------------	-------------------------------------

Included hardware	Computer mounting bracket (VESA 100 × 100 mm)
--------------------------	---

Storage and operating requirements

Storage temperature	-40–140°F (-40–60°C)
----------------------------	----------------------

Certification and compliance

US / Canada	UL (pending), Proposition 65
EU / EEA / EFTA / UK	Packaging, EU and UK REACH, POP, GPSD

Purchasing information

Order number: FS-SBID-200	SMART Heavy Duty Mobile Stand for interactive displays
Optional accessories	See smarttech.com/accessories

Warranty

Included warranty	Five-year limited equipment warranty
--------------------------	--------------------------------------

smarttech.com
smarttech.com/contact

© 2022 SMART Technologies ULC. All rights reserved. SMART Board, smarttech, the SMART logo and all SMART taglines are trademarks or registered trademarks of SMART Technologies ULC in the U.S. and/or other countries. All third-party product and company names may be trademarks of their respective owners. This product and/or use thereof is covered by one or more of the following U.S. patents: www.smarttech.com/patents. Models and specifications may vary by region. Please contact your local representative for details. Contents are subject to change without notice. May 3, 2022.

Installation, dimensions, and weights

Notes

- All dimensions $\pm 1/8"$ (0.3 cm). All weights ± 2 lb. (0.9 kg).
- Product ships horizontally.

FS-SBID-200

Dimensions

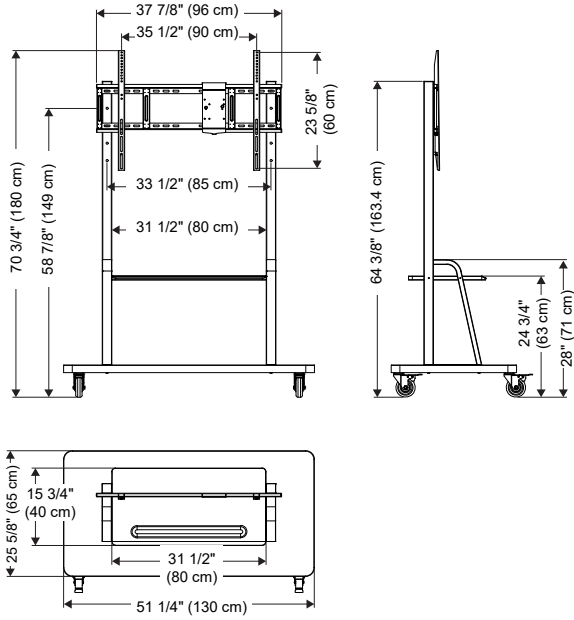

Weight

91 lb. (41.1 kg)

Shipping dimensions (including pallet)

27 1/2" x 62" x 6 3/8"
(70 cm x 158 cm x 16.2 cm)

Shipping weight

102 lb. (46.1 kg)